

# Alternative 1

## Five Multi-Use Diamond Fields

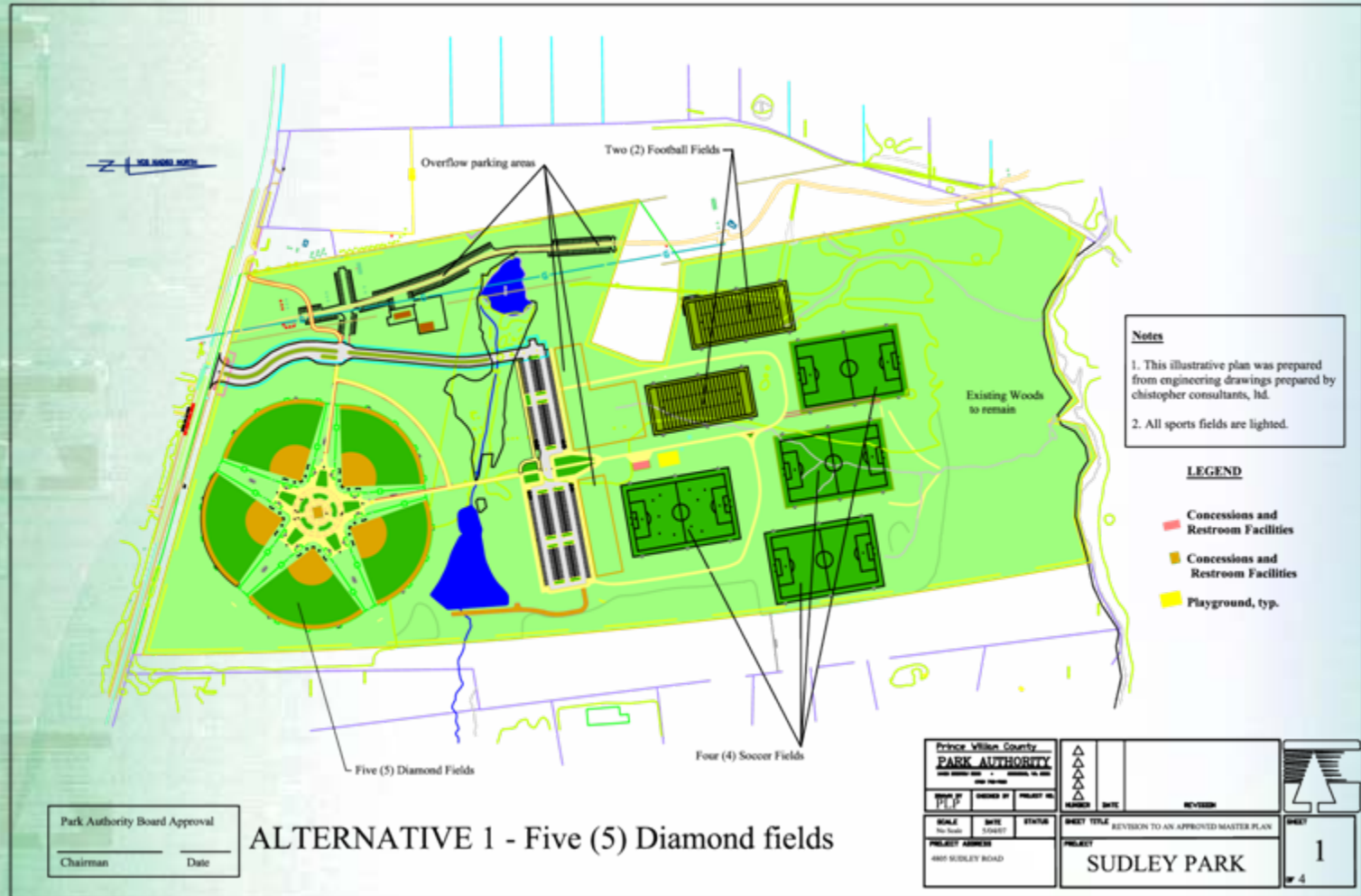

# Option 1

## Construct Park as Multi Use Diamond Fields

The permanent fence line will be 300 feet. All five fields will have netting to stop foul balls, there will be portable mounds and fences for all five fields. All five fields will have skinned infields.

- **Usage:** The facility will be scheduled for Little League or Adult Softball, as need demands. The use of the fields will only be Little League or Adult Softball at any given time. There will not be concurrent mixed use scheduled. The fields will be used for games only and League tournament play.
- **Modifications Needed:** All five fields will require netting. Portable mounds and fences will be required. Costs are: \$50,450 total plus labor to convert fields as use changes
- **Master Plan Changes:** Fields changed to multi-use diamond fields.

### Positives

- Both leagues have access
- Use of fields can be maximized
- Can be constructed as designed
- Design is flexible enough to accommodate future modifications

### Constraints

- Scheduling must be negotiated
- Time to convert fields from one use to the other
- Cost of netting, portable mounds and fencing
- Little league will be playing on skinned infields
- Dirt mounds will need to be constructed for tournament play



# Alternative 2

## Various Field Configurations

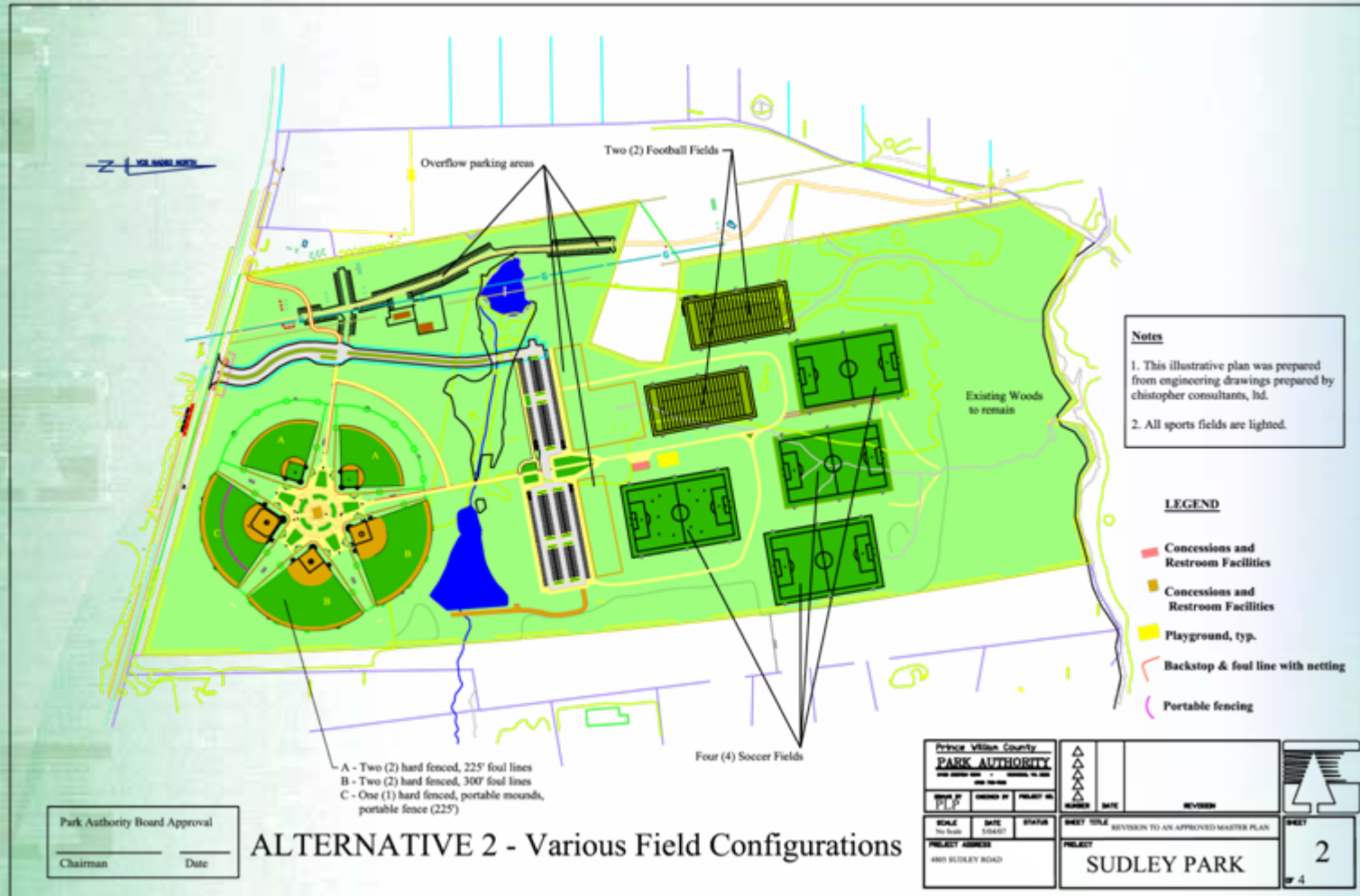



# Option 2

## Construct Park as Two Softball, Two Baseball and One Multi-purpose Diamond Field

The permanent fence line will be 300 feet. All five fields will have netting to stop foul balls, there will be portable mounds and fences for all five fields.

- **Usage:** The facility will be scheduled for Little League or Adult Softball, as need demands. The use of the fields will only be Little League or Adult Softball at any given time. There will not be concurrent mixed use scheduled. The fields will be used for games only and League tournament play.
- **Modifications Needed:** All five fields will require netting. Portable mounds and fences will be required. Costs are: \$60,388 plus in-house labor to set temporary fences per field (TBD).
- **Master Plan Changes:** Fields changed to multi-use diamond fields.

### Positives

- Both leagues have access
- Use of fields can be maximized
- Can be constructed as designed
- Design is flexible enough to accommodate future modifications

### Constraints

- Scheduling must be negotiated
- Time to convert fields from one use to the other
- Cost of netting, portable mounds and fencing
- Little league will be playing on skinned infields if more than two fields are used at the same time
- Dirt mounds will need to be constructed for tournament play



# Alternative 3

## Various Field Configurations

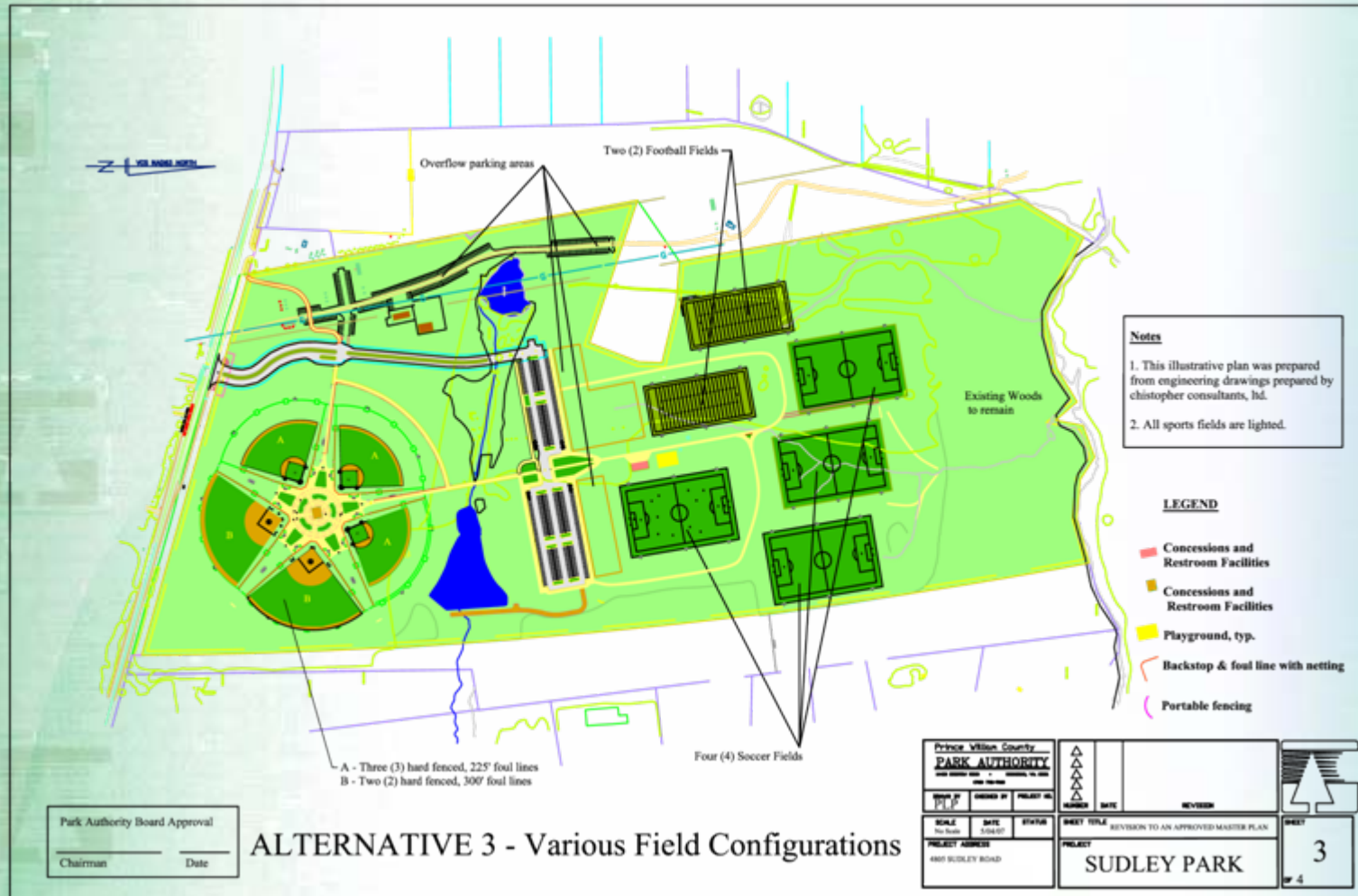

# Option 3

## Construct Park as a Mixed-Use Masterplan with Two Adult Softball Fields and Three Baseball Fields

Two fields will have 300 foot fences for softball. Three fields will have grass infields for youth play and 225 foot fences.

- **Usage:** The facility will be used by both youth and adults seven days a week.
- **Modifications needed:** Three fields will be constructed with a 225 foot fence line and turf infield. These fields will require netting. Cost \$45,177
- **Master Plan Changes:** Change five softball fields to three (3) baseball fields and two (2) softball fields.

### Positives

- Accommodates both Adult Softball and Baseball (youth & adults)
- Field use can be maximized if softball and baseball played at same time

### Constraints

- Field use will not be maximized if only one sport plays at any one time
- Scheduling must be negotiated
- Youth and adults could be playing at the same time
- Cost of modifications \$45,177 total





# Alternative 4

## Various Field Configurations

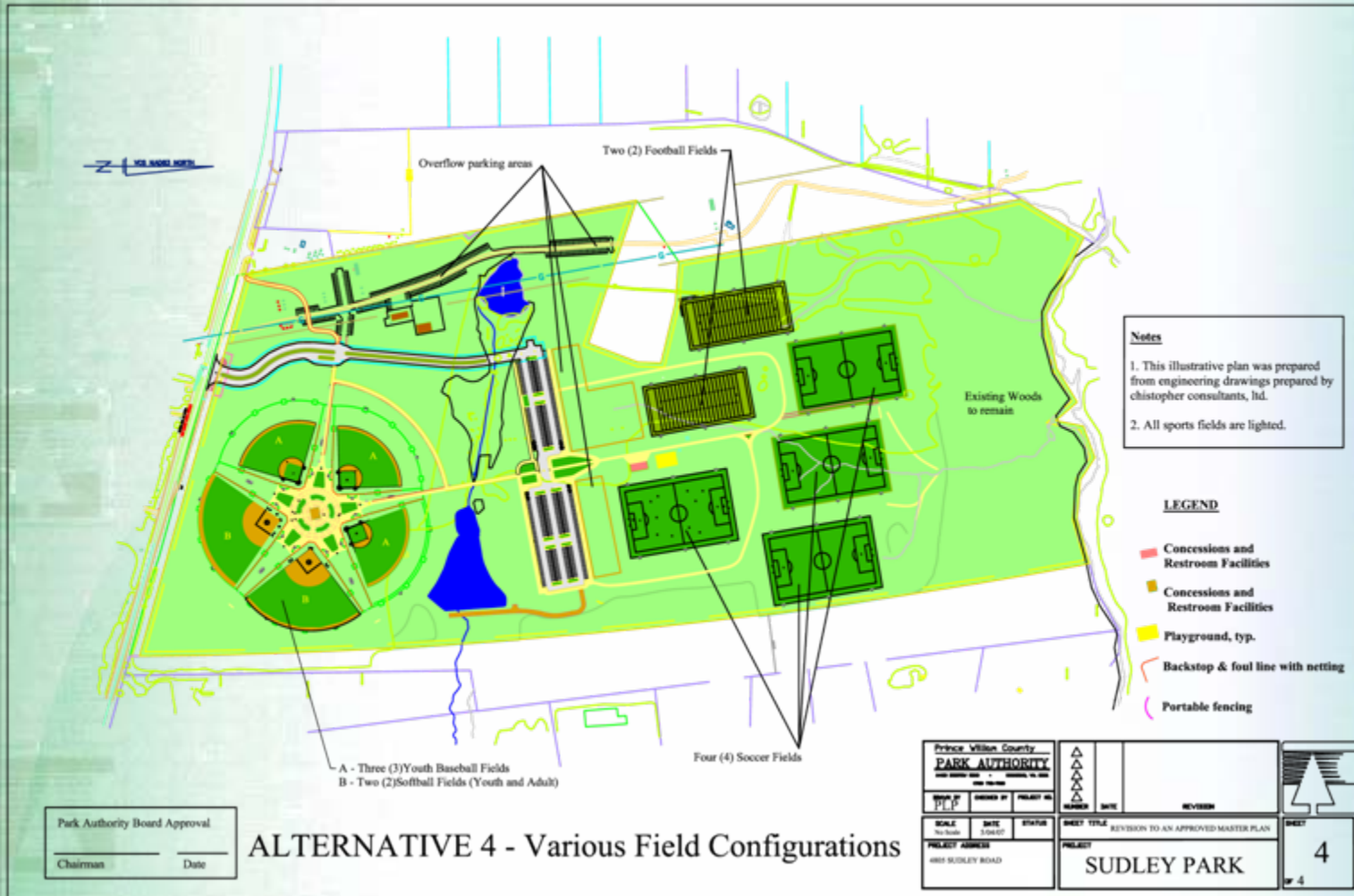

ALTERNATIVE 4 - Various Field Configurations



## Option 4

# Construct Park as a Mixed-Use Masterplan with Two Softball Fields and Three Baseball Fields

Two fields will have 300 foot fences for softball. Three fields will have grass infields for youth play and 225 foot fences.

- **Usage:** The facility will be used by both youth or adults seven days a week. (Non-concurrent use).
- **Modifications needed:** Three fields will be constructed with a 225 foot fence line and turf infield. These fields will require netting. Will require modifications from softball to baseball as needed. Cost for modifications \$77,147 plus labor to install portable fencing.
- **Master Plan Changes:** Change five softball fields to three (3) baseball fields and two (2) softball fields.

### Positives

- Accommodates both Softball and Baseball (youth & adults)
- Field use can be maximized for Little League when all five fields are allocated to baseball.

### Constraints

- Field use will not be maximized when used for softball
- Scheduling must be negotiated
- Cost of modifications \$77,147

